

Scanner Mounting Detail

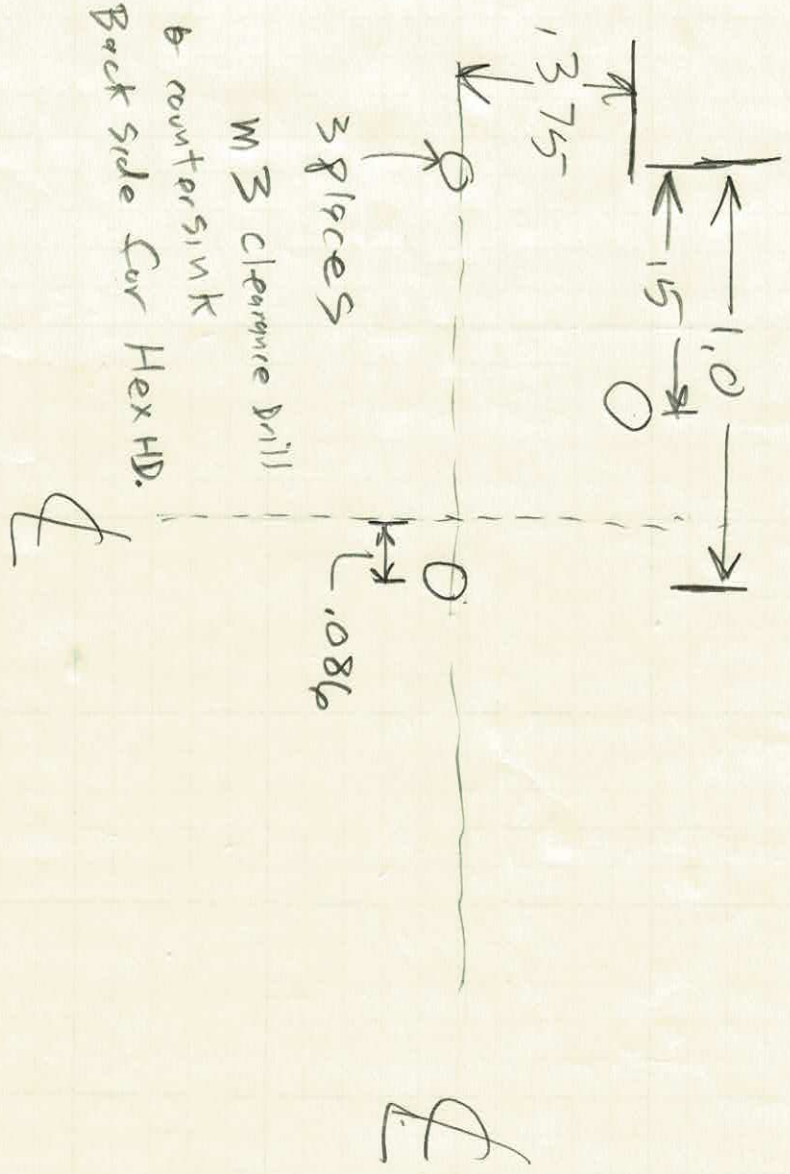

Scanner
Detail

Blank Analyze
 AL (3.8" x 6.0"
 6-3/8")

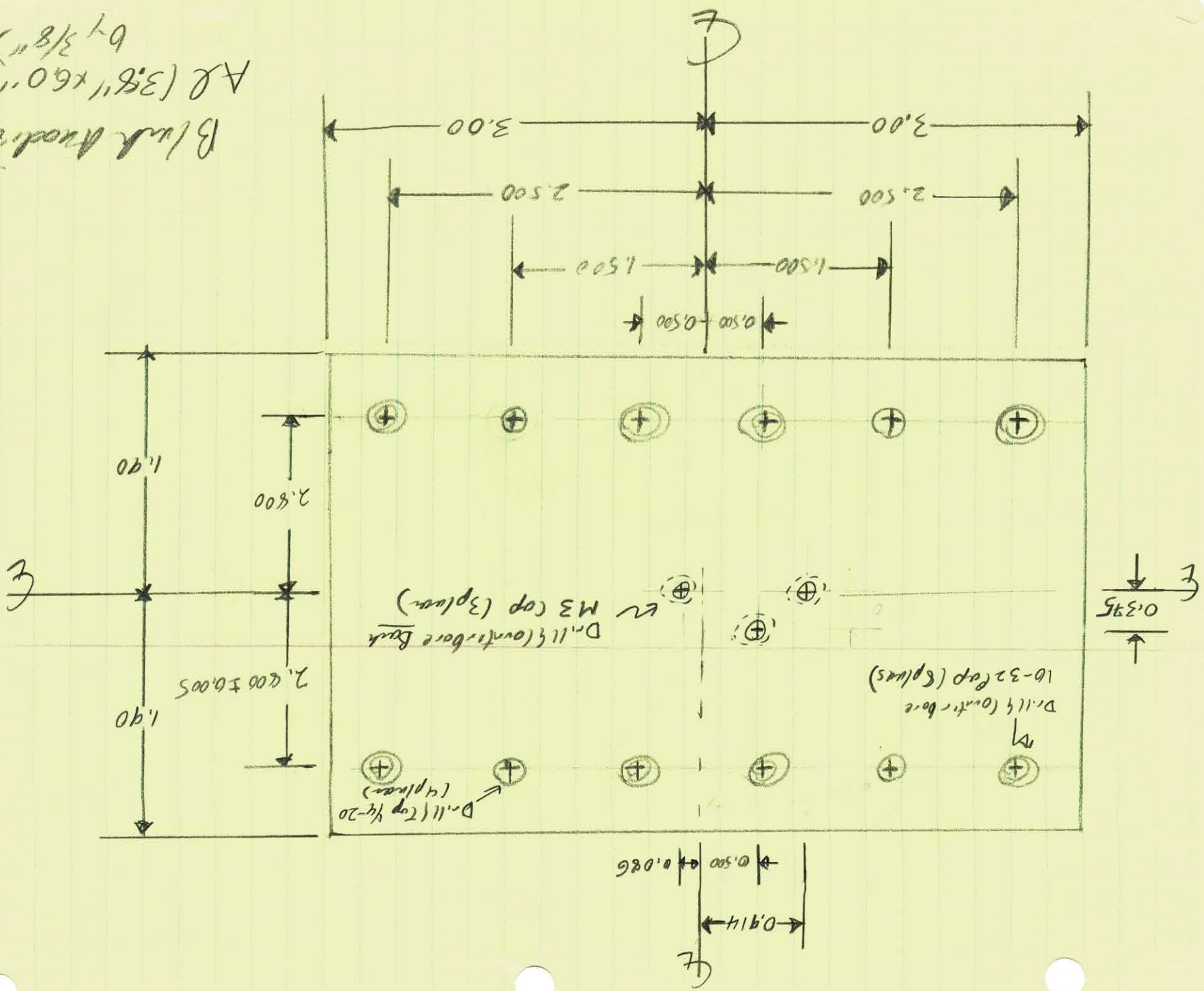

These drawings and specifications are the property of CAMBRIDGE TECHNOLOGY and shall not be reproduced, in whole or in part, or used on the same for the manufacture, or sale of apparatus without the written permission of CAMBRIDGE TECHNOLOGY, INC.

REVISION				
ECO	REV	DESCRIPTION	CHK	DATE

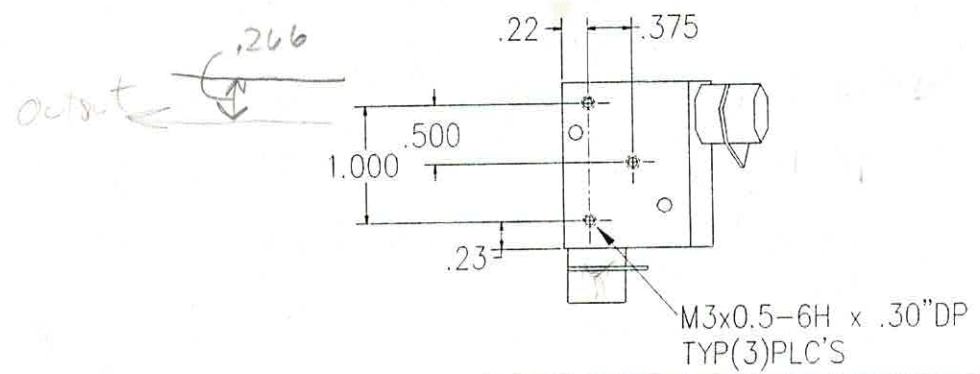
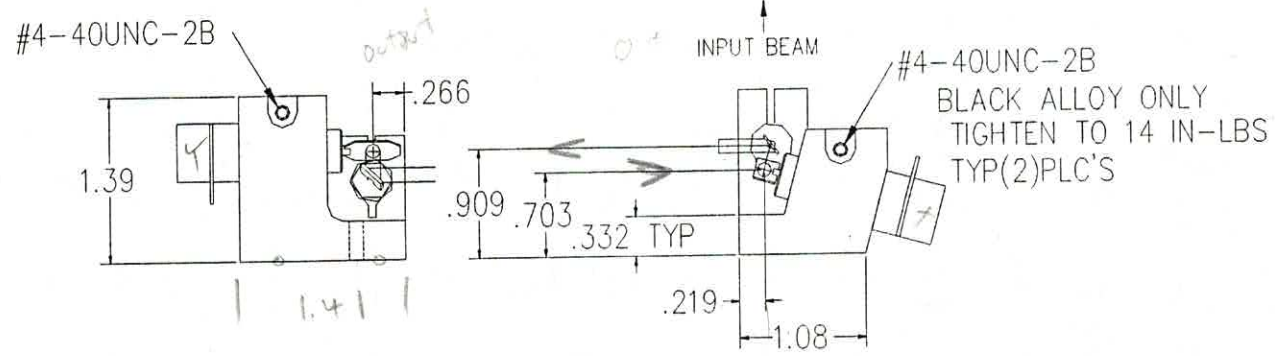
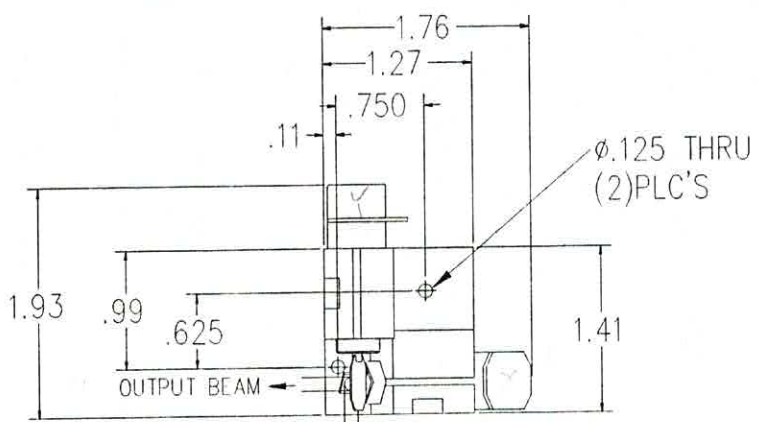

UNLESS OTHERWISE SPECIFIED	DRN	02/09/99	PH	CAMBRIDGE TECHNOLOGY, INC.
TOLERANCES	DES			100 SMITH PLACE
.XX = ±0.010	CHK			CAMBRIDGE, MA 02138 - USA
.XXX = ±0.005	ENG			6210 XY INTERFACE RH
() INDICATES mm	APPR			3mm ±15' MECH
ANGLES: 0°-30°	PRODUCTION			D03793
SURFACE FINISH: $\sqrt{}$	REVISION			SCALE: 2x SHEET 1 OF 1
BREAK ALL SHARP EDGES	A			
MATERIAL				
FINISH				

6200/6210/6215 3mm Mirror Diagram
X Mirror Diagram

J = 2.1mgm²cm²

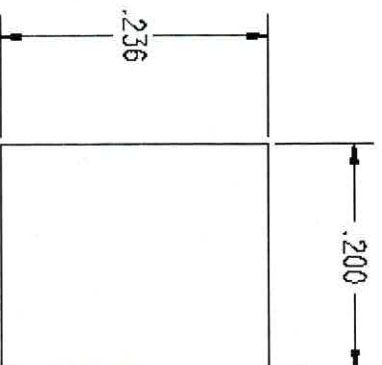

Notes:
(Substrate)

1. Flatness: $\lambda/1$ @633nm
2. Scratch/Dig: 60/40
3. Maximum Chamfer .005
4. Polish both sides

(Coating)

1. Reflective coating on one side
2. Consult CTI engineering for irradiance power ratings.

Y Mirror Diagram

J = 2.4 mgm²cm²

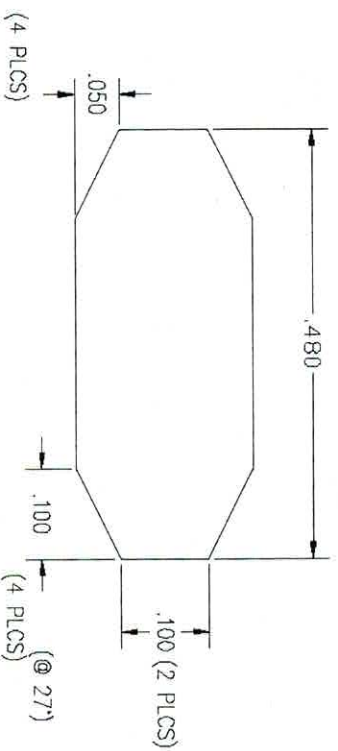

Notes: (Substrate)

1. Flatness: $\lambda/1$ @633nm
2. Scratch/Dig: 60/40
3. Maximum chamfer .005
4. Polish Both Sides

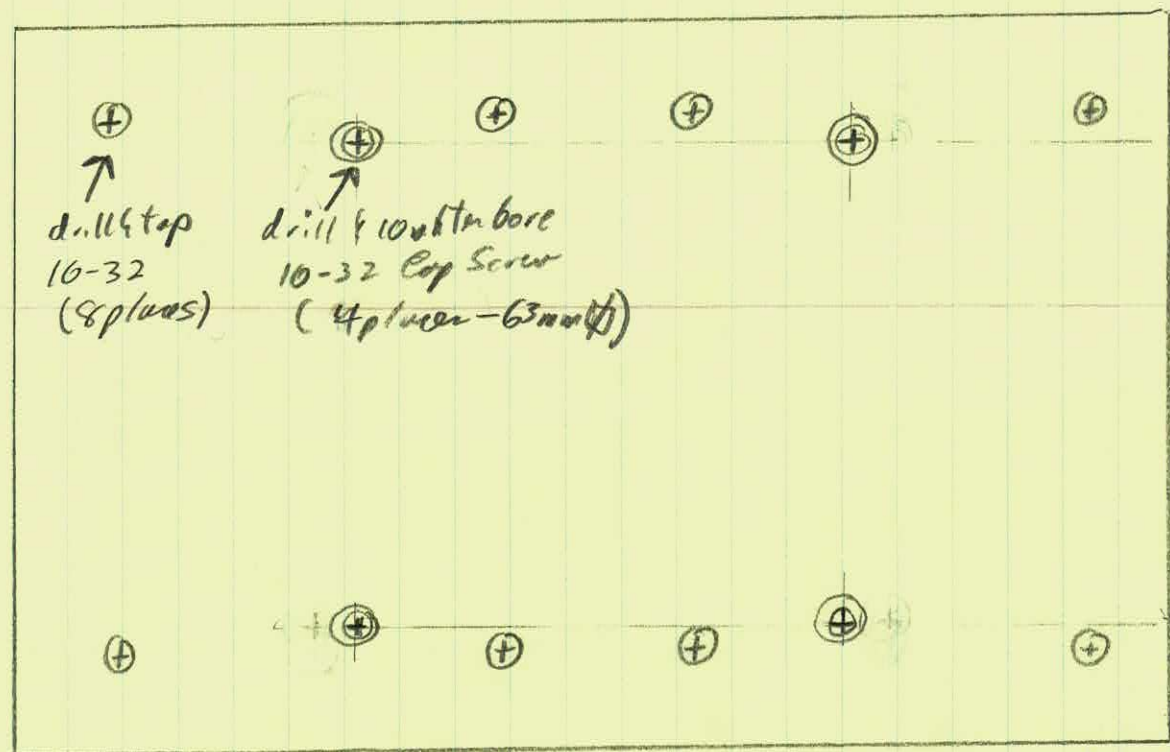

drill top
10-32
(8 places)

drill & tap thru bore
10-32 Cap Screw
(4 places - 63mm dia)

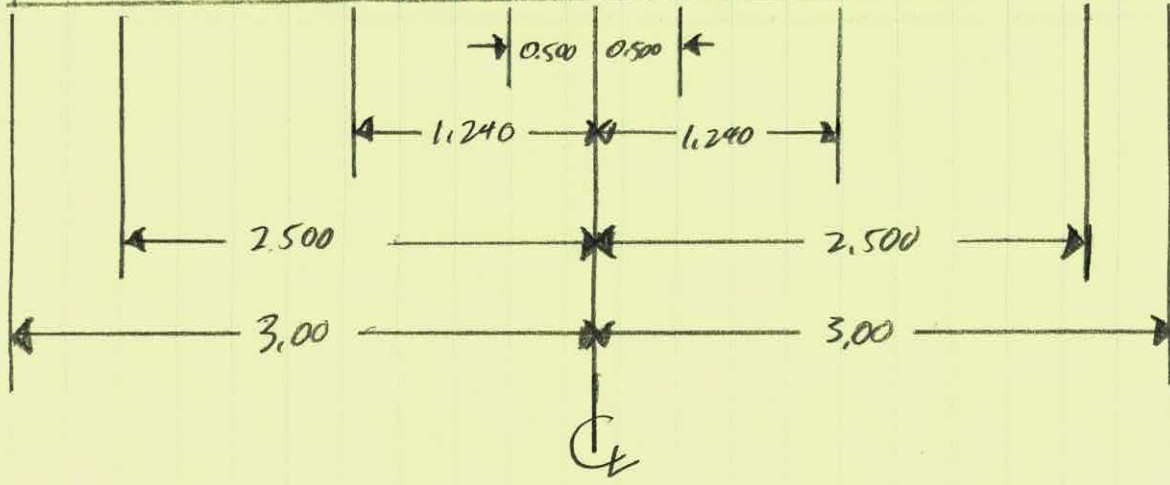
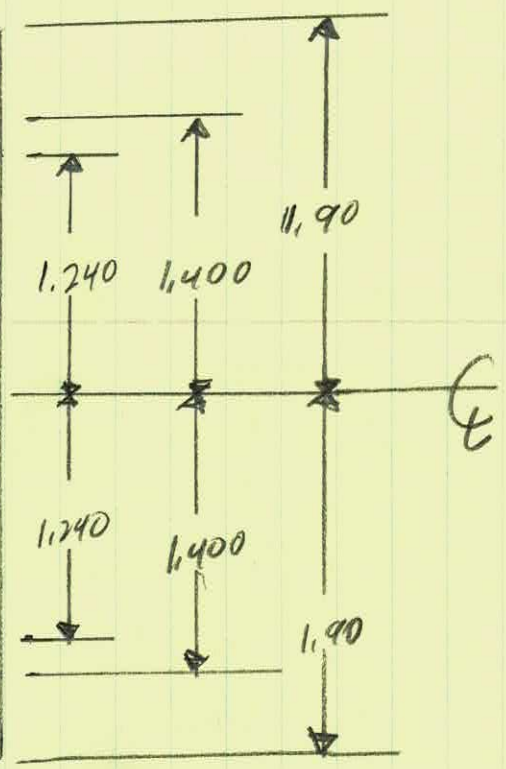

Blind Anodize
AL (3.8" x 6.0"
x 3/8")

(4) Posts 0.50" Dia SS, 304

Tapped one side 1/4-20
 Tapped other side 10-32

Optical Path = 7.000"
 — .375" Top plate
 — .270" Heat sink
 — .375" Bottom plate
 — .909" Scanner (Print)

Post Length = 5.071"

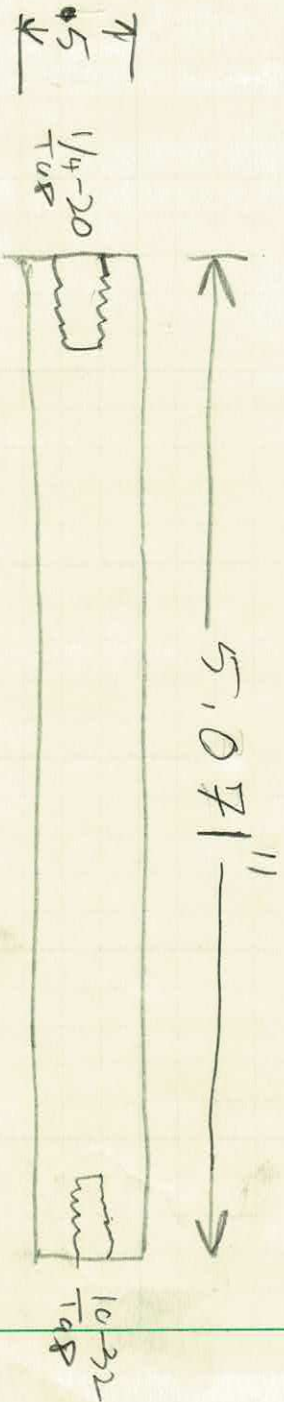

4 Posts

Posts

7

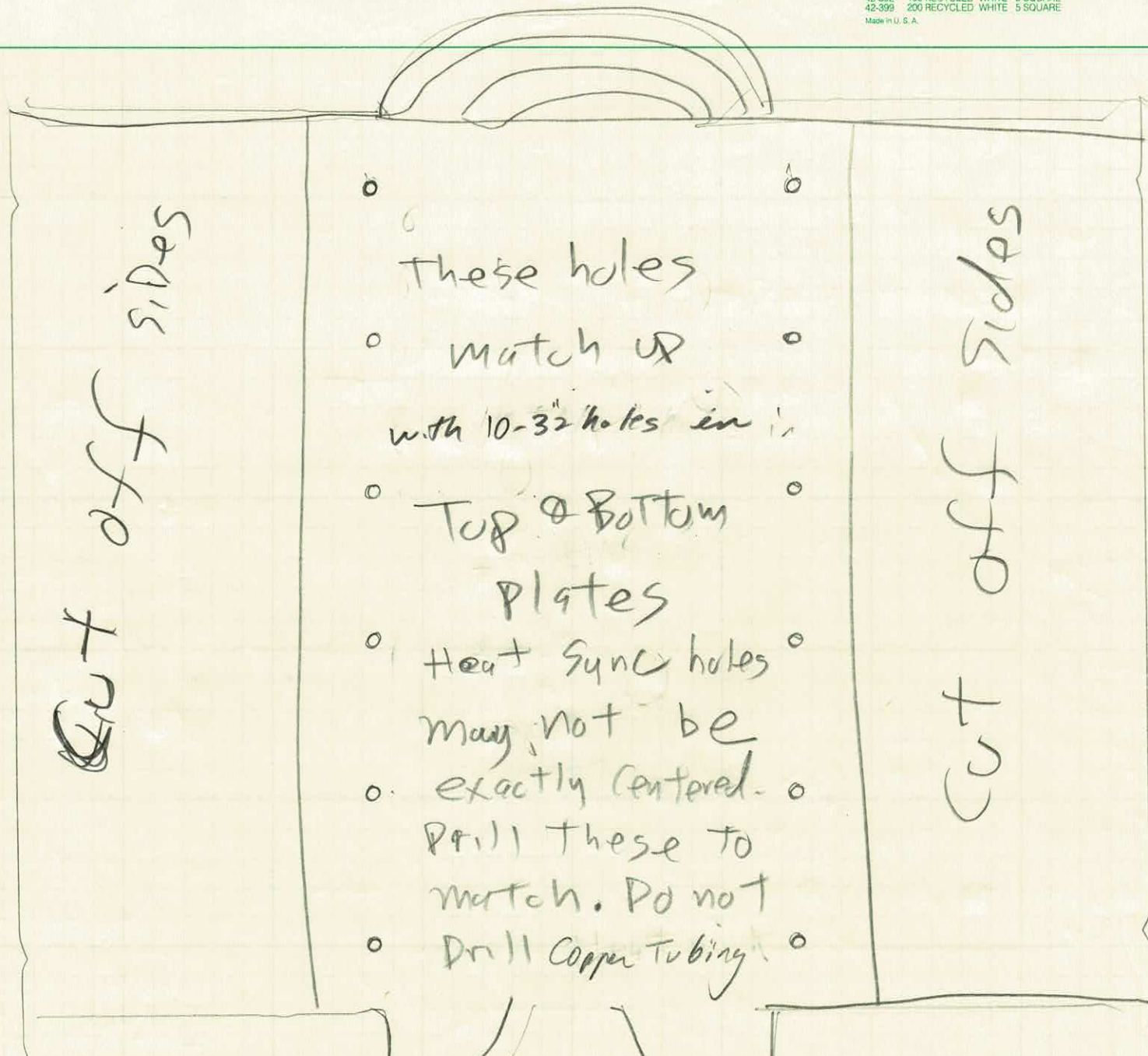

Cut off sides

- o These holes
- o match up
- o with 10-32 holes in
- o Top & Bottom
- o plates
- o Heat Sink holes
- o may not be
- o exactly centered.
- o Drill these to
- o match. Do not
- o Drill Copper Tubing.

Cut off sides

Heat Sink mods

Eye Safety Shield Front Plate

Material : Aluminum, 1/2" thick - BLACK ANODIZED

Tolerances : x.xxx +/- 0.005"

x.xx +/- 0.01"

Description: 1/2" thick plate,
11.00" x 4.25"

Four 1/4-20 counter-bored holes
Two 1/4-20 blind holes into left side of plate

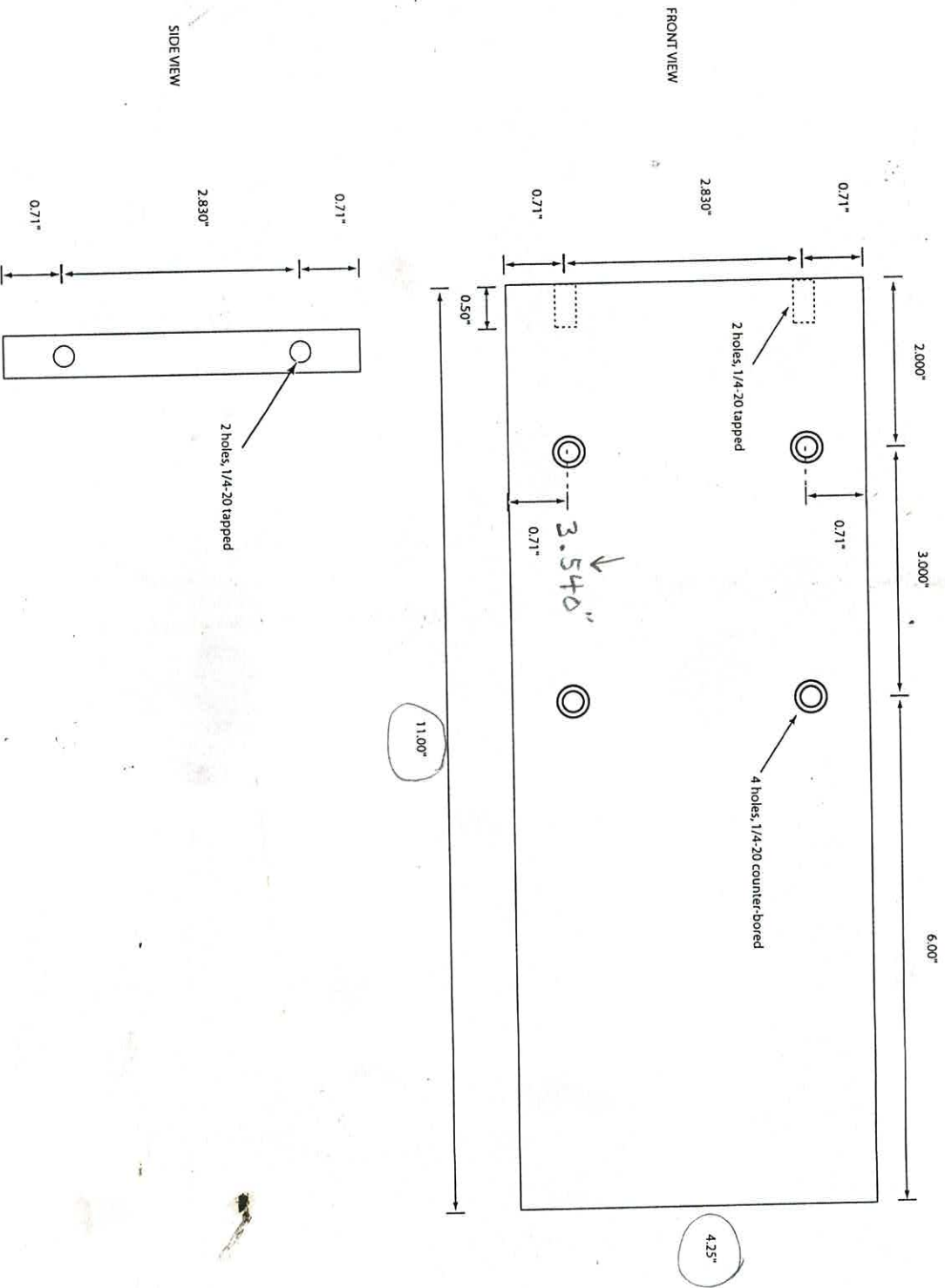

Requestor : Phil Tsai / Kleinfeld Lab 858-534-3562
Quantity : 1

Eye Safety Shield Top Plate

Material : Aluminum, 1/16" thick - BLACK ANODIZED

Tolerances : X.XXX +/- 0.005"

X.XX +/- 0.01"

Description: 1/16" thick plate,
L-shaped with a single 1/4-20 clear hole

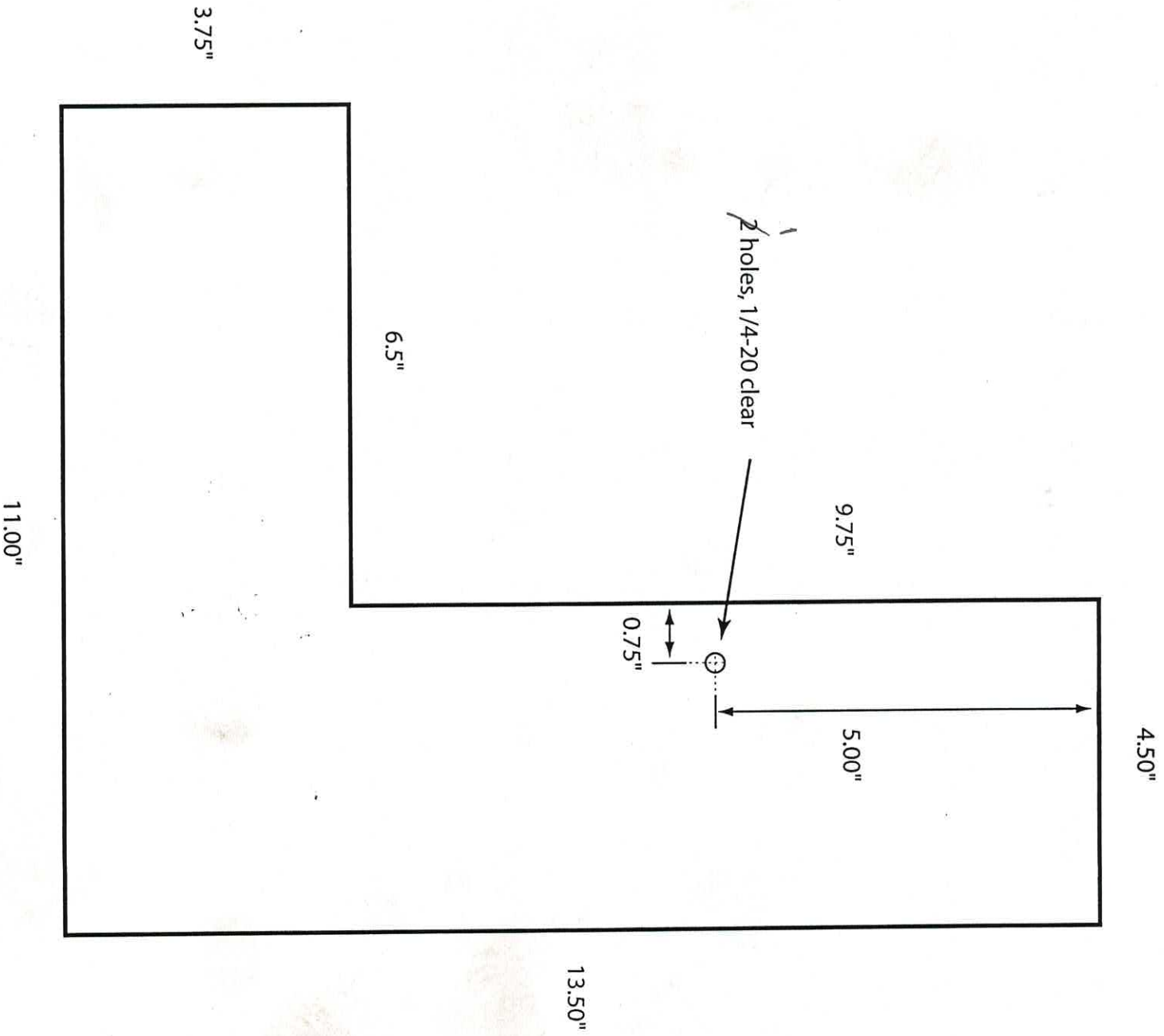

Requestor : Phil Tsai / Kleinfield Lab 858-534-3562
Quantity : 1